

# KIRKLAND-HILLSIDE ROAD VICINITY MAP

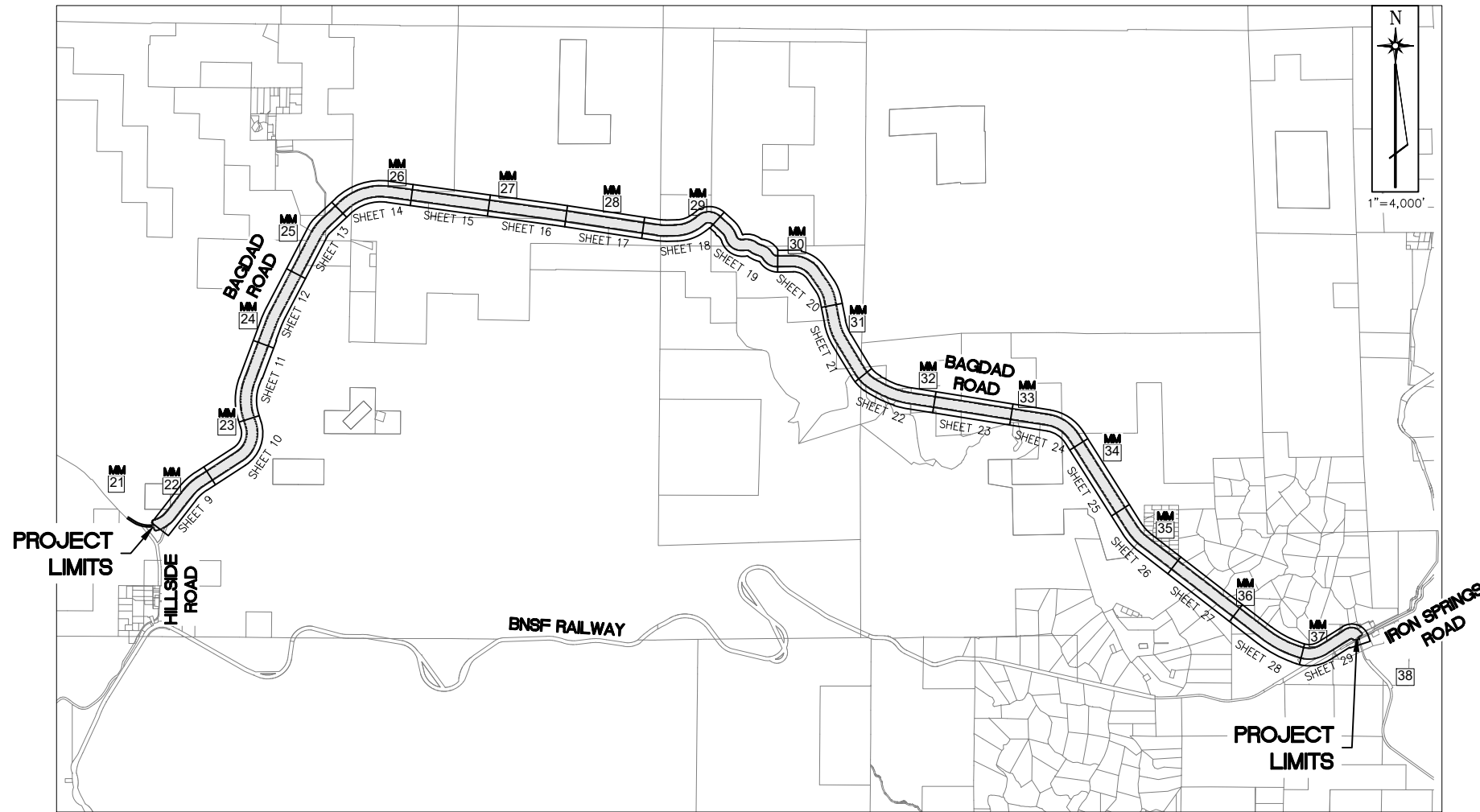

# KIRKLAND-HILLSIDE ROAD GENERAL NOTES

- REGULATORY (POSTED) SPEED LIMIT = 50 MPH STA 1+00 - 393+70  
50 MPH STA 470+15 - 819+05  
35 MPH STA 393+70 - 470+15  
25 MPH STA 819+05 - END
- AVERAGE DAILY TRAFFIC (ADT) = 857
- LENGTH OF PROJECT = 83,834 LF

DESCRIPTION	QUANTITY	UNIT
1" Hot In-Place Recycling (22' Pavement Sections)	199,164	SY
Fiber Reinforced Asphaltic Concrete Pavement Overlay, 1/2" High Traffic, PG 64-22	25,360	TN
Thickened Edge Pavement Preparation	167,820	LF
Shoulder Build-Up and Grading	167,820	LF
Shouldering Material	3,105	CY
Bituminous Tack Coat (0.10 GAL/SY)	600	GAL
Recycling Agent (0.10 GAL/SY)	19,916	GAL
Pavement Match Type "ML1"	8	EA
Pavement Match Type "ML2"	2	EA
Pavement Match Type "G-1"	29	EA
Pavement Match Type "C-1"	7	EA
Remove and Replace Sections with Geogrid	1,468	SY
Bituminous Pavement Removal by Milling	900	SY
Bituminous Pavement Removal by Milling, Taper Mill	74	SY
Striping, Yellow (4" Equivalent)	488,520	LF
Striping, White (4" Equivalent)	503,745	LF
Thermoplastic Pavement Markings - White (4" Equivalent)	213	LF
Thermoplastic Right Turn Arrow Pavement Marking	2	EA
Thermoplastic Left Turn Arrow Pavement Marking	4	EA
Thermoplastic School Pavement Marking	1	EA
Thermoplastic Railroad Pavement Marking	1	EA
Thermoplastic "ONLY" Pavement Marking	3	EA
Install Rumble Strips	108	LF
Remove and Dispose of Existing Guardrail	1101	LF
Guardrail Transition to Bridge Per ADOT Standard Detail C-10.31	4	EA
Guardrail, W-Beam, Single Face, Steel Posts with Mondo Blocks	800	LF
Install New Terminal End Treatment (MSKT, TL3)	16	EA
Adjust Guardrail Height by Raising Blocks	1,688	LF
Remove and Replace Damaged Wood Posts (72")	20	EA
Remove and Replace Damaged Wood Blocks (8")	50	EA
Remove and Replace Embankment Curb (ADOT STD DWG C-05.10)	690	LF
Remove Existing Cattle Guard	6	EA
Install New Cattle Guard	5	EA
Install Type 2 Barbed Wire Fence Per ADOT Standard Detail C-12.10	185	LF
Install 10' Single Gate Per Type 1 ADOT Standard Detail C-12.10	4	EA
Install New Sign Base	202	EA
Install Flexible Delineator Assembly with Base	6	EA
Mobilization	1	LS
Construction Survey and Layout	1	LS
Traffic Control	1	LS
Force Account	1	LS

TABLE OF EXISTING SIGN LOCATIONS

MUTCD	Mile Post	Position	Sign Legend	MUTCD	Mile Post	Position	Sign Legend	MUTCD	Mile Post	Position	Sign Legend
M1-6	21.648	Right	15	S3-1	25.54	Right		M1-6	30.77	Right	15
M3-2	21.648	Right		W8-108	25.64	Right		D10-2	31	Right	Mile 31
M4-11	21.648	Right		R1-1	25.69	Left		D10-2	31	Left	Mile 31
D2-3'	21.707	Right	Kirkland 16, SR 89 21, Prescott 42	OM3-R	25.782	Right		OM3-R	31.387	Left	
				OM3-L	25.782	Left		S3-1	31.392	Right	
YCW-015	21.904	Left		OM3-R	25.785	Left		OM3-R	31.405	Left	
W8-108	21.958	Right		OM3-L	25.785	Right		W1-8L	31.467	Right	
D10-2	21.998	Left	Mile 22	S3-1	25.8	Left		W1-8L	31.5	Right	
D10-2	21.998	Left	Mile 22	W8-108	25.906	Left	Mile 26	W1-8L	31.535	Left	
W11-4	22.026	Left		D10-2	25.996	Left	Mile 26	S3-1	31.831	Right	
OM3-R	22.048	Right		D10-2	26.997	Right	Mile 26	S3-1	31.86	Left	
OM3-L	22.048	Left		D10-2	26.997	Left	Mile 27	W11-3	31.98	Right	
OM3-R	22.051	Right		D10-2	27.996	Right	Mile 27	D10-2	32	Right	Mile 32
OM3-L	22.051	Left		D10-2	27.996	Left	Mile 28	D10-2	32	Left	Mile 32
W11-4	22.056	Left		W8-108	28.471	Right		S3-1	32.054	Right	
D10-2	22.997	Right	Mile 23	OM3-R	28.603	Right		S3-1	32.223	Left	
D10-2	22.997	Right	Mile 23	OM3-L	28.603	Left		D10-2	33	Left	Mile 33
W7-11	23.11	Right		OM3-L	28.605	Right		D10-2	33	Right	Mile 33
W8-108	23.853	Right		OM3-R	28.605	Left		R2-1'	33.548	Right	50
YCW-043	23.856	Left		OM3-R	28.605	Right		D10-2	34	Left	Mile 34
OM3-L	23.975	Left		W11-4	28.621	Right		D10-2	34	Right	Mile 34
OM3-R	23.975	Right		W8-108	28.733	Left		S3-1	34.876	Right	
OM3-R	23.981	Left		W3-5AAZ	28.739	Right		D10-2	35	Right	Mile 35
OM3-L	23.981	Right		R2-1'	28.887	Right	35	D10-2	35	Left	Mile 35
D10-2	23.998	Right	Mile 24	R2-1'	28.888	Left	50	S3-1	35.249	Left	
D10-2	23.998	Right	Mile 24	W1-5L	28.906	Right		R2-1'	35.742	Left	50
W8-108	24.096	Left		W8-14	28.959	Right		D10-2	36	Right	Mile 36
S3-1	24.663	Right		D10-2	28.994	Left	Mile 29	D10-2	36	Left	Mile 36
R2-1'	24.762	Right	50	D10-2	28.995	Right		W11-3	36.258	Left	
R2-1'	24.793	Left	50	S3-1	29.68	Right		D10-2	37	Right	Mile 37
OM3-R	24.976	Right		OM3-R	29.825	Left		D10-2	37	Left	Mile 37
OM3-L	24.983	Left		S3-1	29.888	Left		R2-5A	37.03	Right	
YCW-044	24.988	Right		D10-2	29.998	Right	Mile 30	D2-2'	37.152	Right	
D10-2	24.998	Right	Mile 25	D10-2	29.998	Left	Mile 30				
D10-2	24.998	Left	Mile 25	W8-108	30.178	Right					
YCW-044	25.141	Left		W11-4	30.291	Left					
OM3-L	25.148	Right		R2-1'	30.332	Right	50				
OM3-R	25.155	Left		R2-1'	30.332	Left	35				
R2-1'	25.2	Left	50	R2-1'	30.437	Right					
OM3-R	25.241	Right		W1-5R	30.437	Left					
OM3-L	25.241	Left		W3-5AAZ	30.445	Left					
OM3-R	25.244	Right		W8-108	30.5	Left					
OM3-L	25.244	Left		W8-14	30.635	Left					
R1-1	25.248	Left		M1-6	30.769	Left	15				
S3-1	25.321	Right									
W8-108	25.355	Left									
R2-1'	25.394	Left	50								

SIGN BASE INSTALLATION NOTES:

- 2-POST SIGN ASSEMBLY
- COUNTY WILL LAYOUT EXACT LOCATION FOR SIGN BASE INSTALLATION.
- INSTALL SIGN BASE PER ADOT TRAFFIC SIGNING AND MARKING STANDARD DRAWINGS S-3 (15/16).
- EXISTING SIGNS SHALL REMAIN IN PLACE DURING CONSTRUCTION.

## KIRKLAND-HILLSIDE ROAD UTILITY COMPANY NOTES

THE FOLLOWING LISTING OF COMPANIES REPRESENT UTILITIES THAT MAY EXIST IN THE AREA. UTILITIES ARE NOT SHOWN ON THESE PLANS AND IT IS THE SOLE RESPONSIBILITY OF THE CONTRACTOR TO DETERMINE THE EXISTENCE OF UTILITIES IN THE AREA AND NOTIFY BLUE STAKE AT LEAST 48 HOURS PRIOR TO INITIATING ANY CONSTRUCTION AT THE SITE.

**ELECTRIC**  
 APS - PRESCOTT  
 ELM LOCATORS/RECALLS AND UNKNOWNNS  
 623-780-3350  
 602-371-7171 (EMERGENCY)

**CATV, FIBER OPTICS**  
 NPG CABLE, LLC - SEDONA  
 SUDDENLINK  
 MATT HERMAN  
 480-450-3889



**YAVAPAI COUNTY PUBLIC WORKS DEPARTMENT**  
 1100 COMMERCE DR. PRESCOTT, ARIZONA 86305  
 (928) 771-3183  
 DAN CHERRY, P.E., CFM - PUBLIC WORKS DIRECTOR

PROJECT NAME: <b>KIRKLAND- HILLSIDE PAVEMENT IMPROVEMENT PROJECT</b>	PROJECT NUMBER: 19-22884
SHEET NAME: <b>VICINITY MAP</b>	DRAWN BY: D.J.C.
	CHECKED BY: J.S.
	DATE: 5/12/2020
	SHEET: 3 OF 29